



**TWISTED
THROTTLE**.COM

Bolt-On Touring Accessories that fit YOUR motorcycle!

Steel Top Rack

Honda GoldWing F6B
GPT.01.10000

- Enables use of Quick-Lock adapters
- Accepts Givi, Coccase, Pelican, Trax and many others
- Mounts with or without OEM Backrest
- All mounting hardware included



PLEASE READ BEFORE INSTALLING

TWISTED THROTTLE products should be installed by a qualified, experienced motorcycle technician. If you are unsure of your ability to properly install a product, please have the product installed by your local motorcycle dealer. TWISTED THROTTLE takes no responsibility for damages caused by improper installation.

Medium strength liquid thread-locker (i.e., "Locktite") should be used to secure all screws, bolts, and nuts.

All screws, bolts, and nuts should be checked after driving the first 30 miles (50 km) to ensure that all are tightened to the proper torque.

All screws, bolts, and nuts, including all replacement hardware provided by TWISTED THROTTLE should be tightened to the torque specified in the OEM maintenance manual for your motorcycle. If no torque specifications are provided in the OEM maintenance manual, the following torques may be used:

M5.....	3.5 ft-lbs (5 Nm)
M6.....	6.5 ft-lbs (9 Nm)
M8.....	16 ft-lbs (22 Nm)
M10.....	32 ft-lbs (43 Nm)
M12.....	55 ft-lbs (75 Nm)



Instruction Rev: 00

Twisted Throttle LLC
570 Nooseneck Hill Rd
Exeter, RI 02822

Phone: 401.284.4200
Fax: 401.223.6954
www.twistedthrottle.com

Step 2

1
Rack Bracket (Left)

GPT.01.008
Qty.....1

2
Rack Bracket (Right)

GPT.01.009
Qty.....1

3
Hex Head Screw

M8x25.....DIN 933
Qty.....4

4
Washer

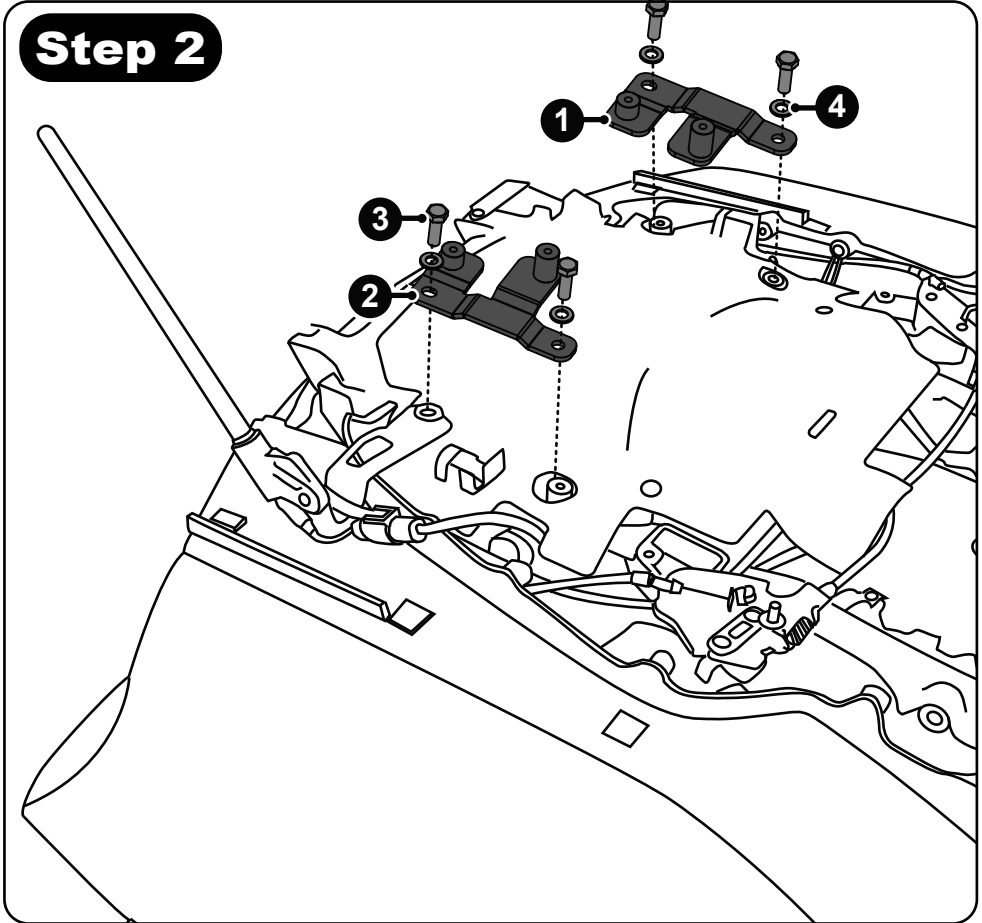
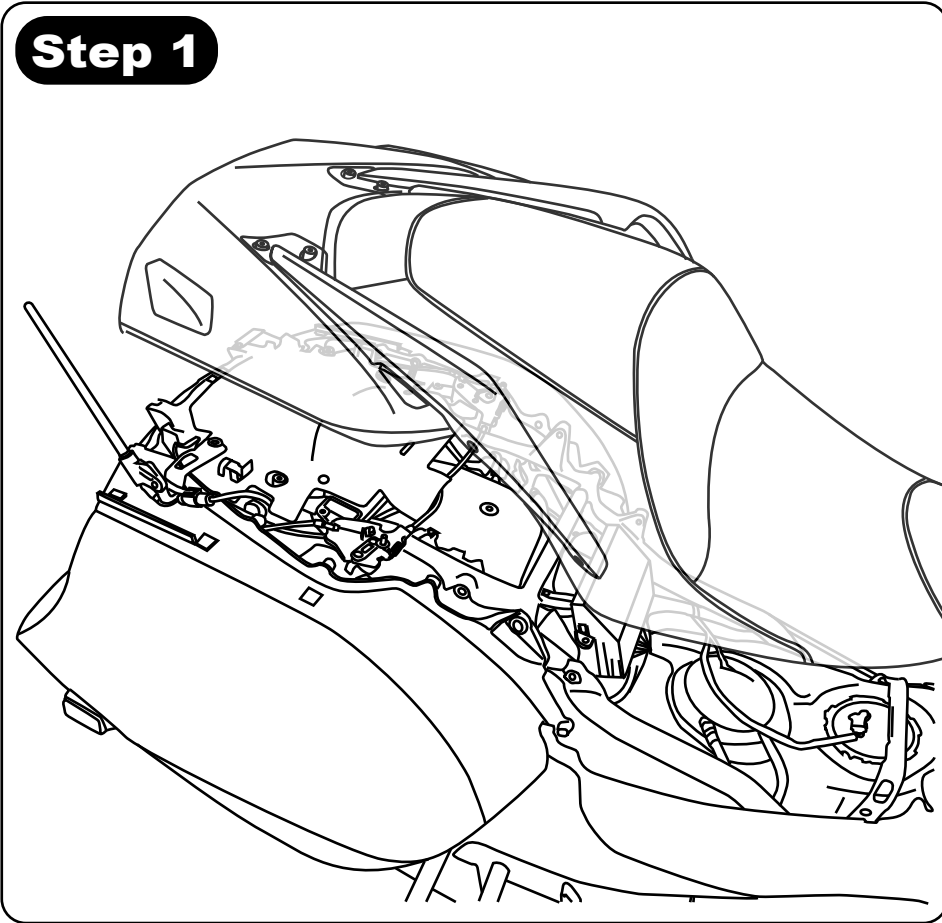
M8.....DIN 125
Qty.....4



Step One: Remove the seat, grab rails and rear center top cover plastics to expose the 4 mounting points illustrated above.

Step Two: (If replacing the OEM rack you will need to first remove the OEM rack brackets.) Using the supplied hardware bolt the two rack brackets to the motorcycle.

Step 3

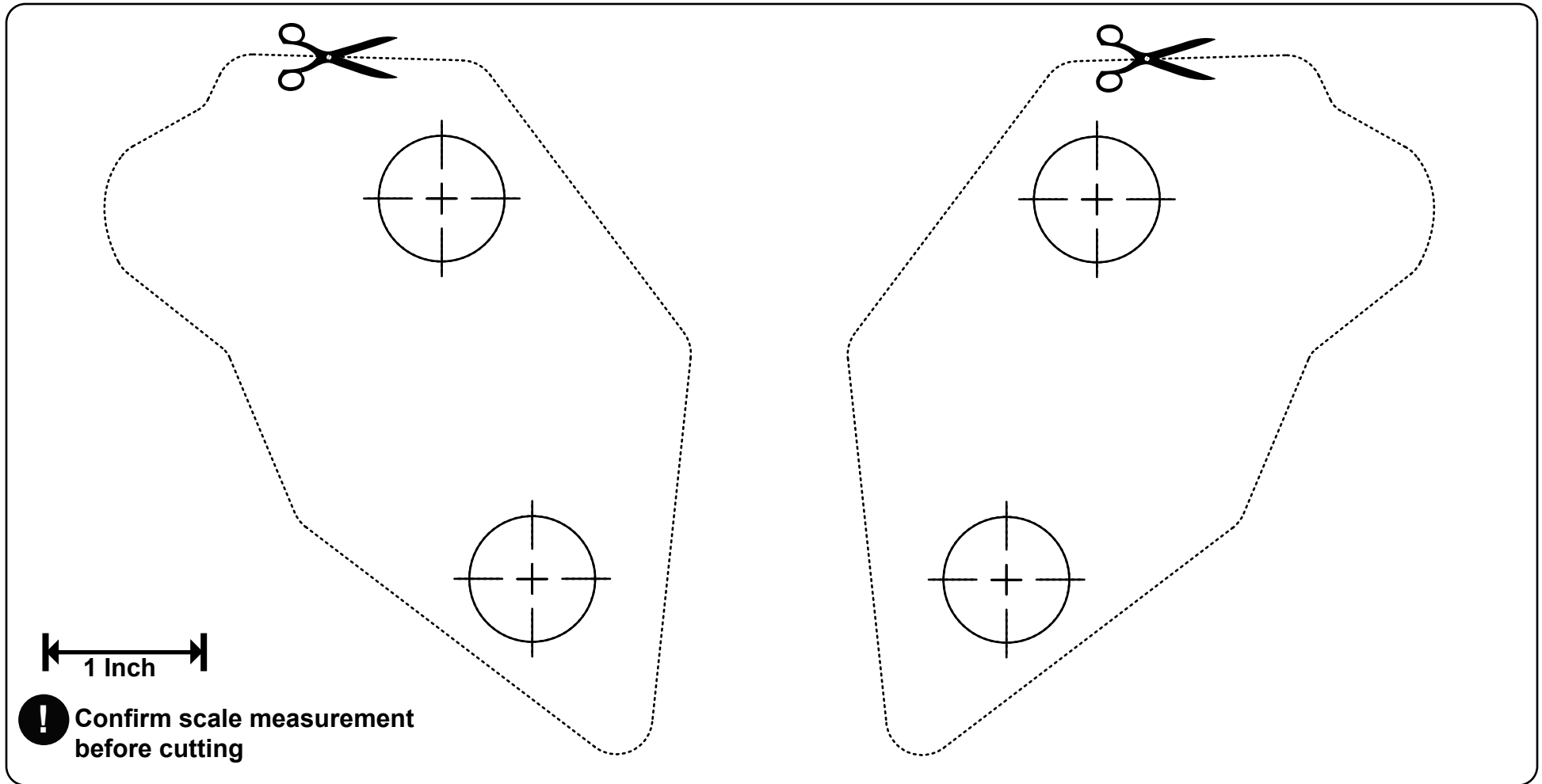

Step Three: Remove the top cover lids from the center top plastic. Cut out the drilling templates along the dotted line. Use tape to adhere the templates to the top cover lids. Using a center punch, mark the hole centers onto each top cover lid, then drill each hole using a 7/8" hole saw. Once drilled reinstall the top cover lids to the center top plastic. (Do not scale when printing, check scale with ruler before cutting)

Note: Predrilled top cover lids are available for purchase from Honda OEM parts dealers, and can be ordered using the part numbers below.

Magna Red:

Right - 81551-MJG-770ZA

Left - 81552-MJG-770ZA

Graphite Black:

Right - 81551-MJG-770ZB

Left - 81552-MJG-770ZB

Step 4

5
Steel Rack

GPT.01.003
Qty.....1

6
Countersunk Screw

M6x50.....DIN 7991
Qty.....2

7
Spacer

ID: 6.5mm OD: 15.9mm L: 28mm
Qty.....2

8
Countersunk Screw

M6x60.....DIN 7991
Qty.....4

9
Spacer

ID: 6.5mm OD: 15.9mm L: 46mm
Qty.....2

10
Countersunk Screw

M6x70.....DIN 7991
Qty.....2

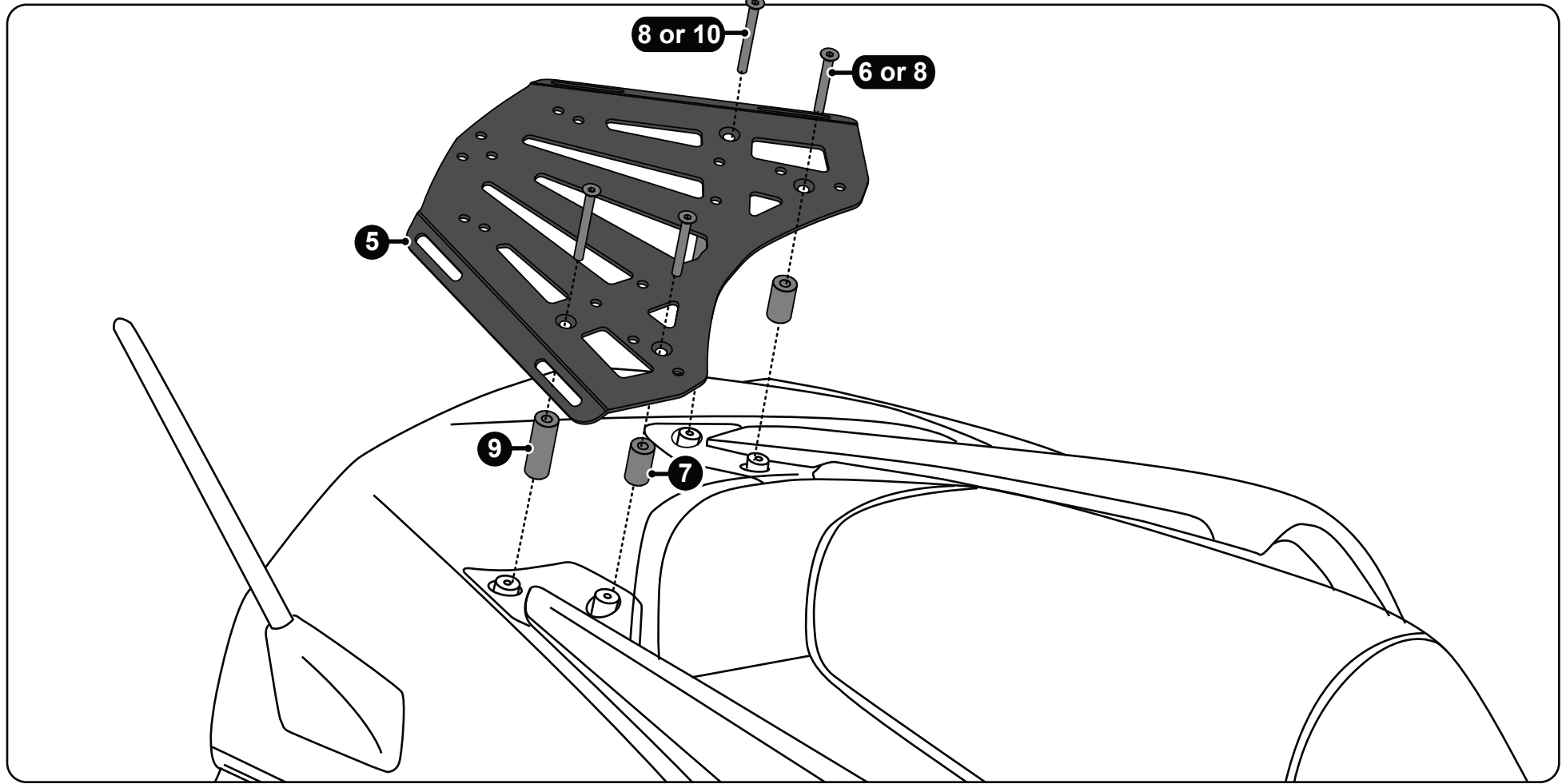

Step Three: With the rack brackets bolted in place reinstall the rear center top cover plastics, grab rails and seat. Use the supplied spacers to level the rack, then bolt the steel rack to the brackets. (If installing with OEM backrest use the longer bolts to attach the steel rack to the brackets)